

# EXP-86

REVISION: -  
ECO NO.: -  
BY: G. REEDER  
DATE: 4/7/10

# COXREELS SG WELD SERIES

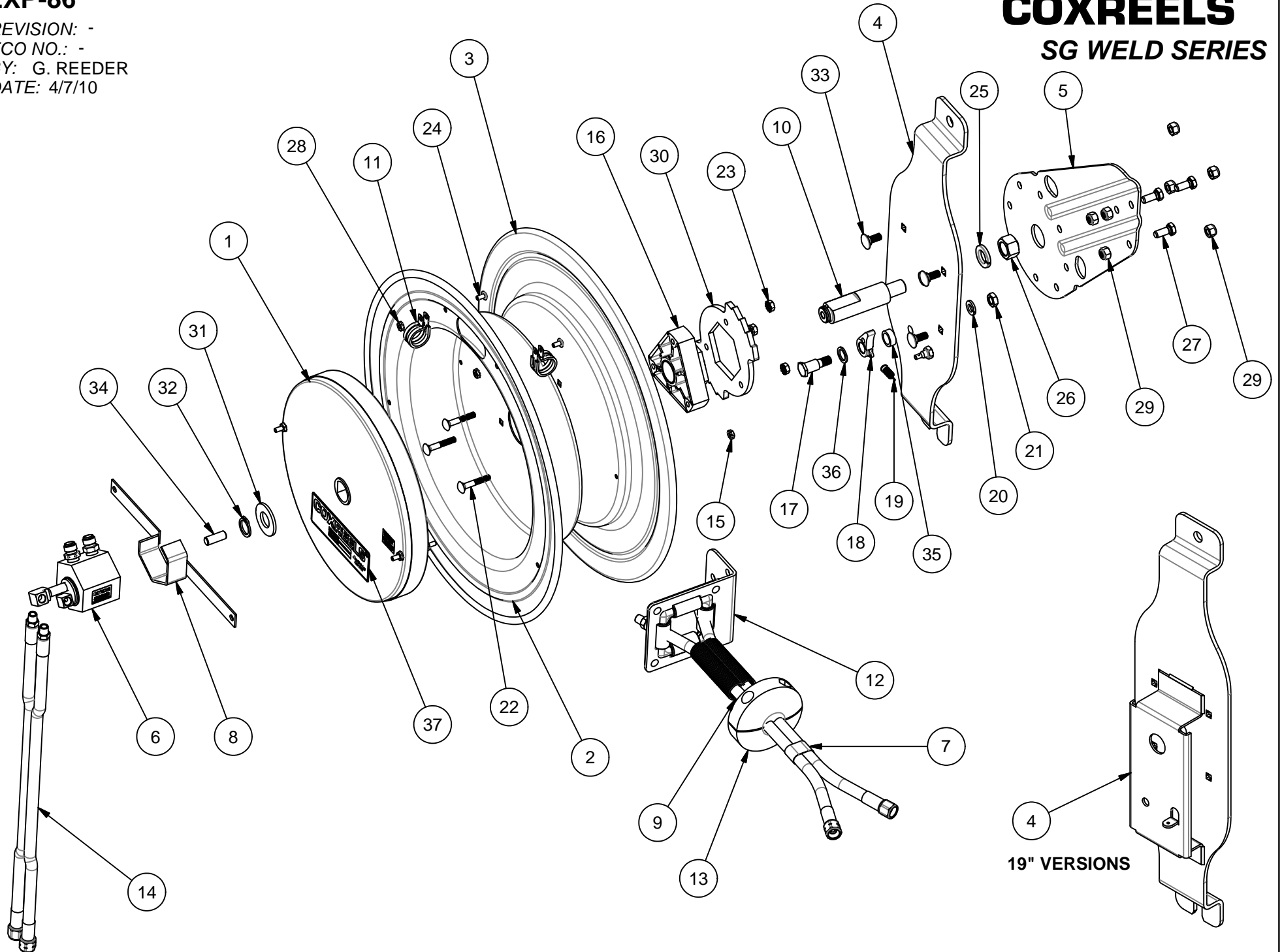

19" VERSIONS

ITEM	PART	DESCRIPTION	QTY
16	1776-3	ASSY.: HUB BEARING	1
17	1620	BOLT: 1/2" x 1-1/2" SHOULDER	1
18	640-1-BR	CAM: LOCKING	1
19	274-1-SS	SPRING: LOCK DOG	1
20	437	WASHER: 3/8" LOCK	1
21	184	NUT: 3/8-16 JAM	1
22	1953	BOLT: 1/4-20 x 1-1/2" CARRIAGE	3
23	125	NUT: 1/4-20 KEPS	3
24	245	SCREW: #10-32 x 3/8" TRUSS HEAD	2
25	438	WASHER: 5/8" LOCK	1
26	3584	NUT: 5/8-11 HEX	1

ITEM	PART	DESCRIPTION	QTY
27	312	BOLT: 5/16-18" X 3/4" HEX	3
28	130	NUT: #10-32 KEPS	2
29	111	NUT: 5/16-18 NYLOCK	7
30	1924	RING: LOCKING	1
31	1755-1	WASHER: SPACER	1
32	1753	RING: #5160-75 RETAINING	1
33	10220-75	BOLT: 5/16-18 x 3/4" CARRIAGE	4
34	10235-SS	STUD: 3/8-16 X 1" SS	1
35	6440-SS	SPACER: SS	1
36	6441-1	WASHER, SPACER	1
37	10925-5	LABEL: STANDARD PRODUCT	1

ITEM NUMBER

MODEL NO.	1	2	3	4	5	6	** 7	8	** 9	10	11	12	** 13	** 14	15
	SPRING	DRUM	DRUM	BASE	ARM	SWIVEL	HOSE ASSY.	BRACKET	HOSE GRD	AXLE	CLAMP	ROLLER B.	BALL STOP	HOSE ASSY.	NUT
SG17W-150	1961-2	1948	1947	8873	8867	498	5423-50	1802-1	237-1 (2)	1956	382 (2)	1728-3	633	5423-1.5	130 (2)
SG17WT-150	1961-2	1948	1947	8873	8867	498	5424-50	1802-1	237-1 (2)	1956	382 (2)	1728-3	633	5424-1.5	130 (2)
SG19W-175	691-4	1703	1702	8870	8869	498	5423-75	1802	237-1 (2)	1793	382 (2)	1728-1	633	5423-1.5	125 (4)
SG19WT-175	691-4	1703	1702	8870	8869	498	5424-75	1802	237-1 (2)	1793	382 (2)	1728-1	633	5424-1.5	125 (4)

\*\* ON "LESS HOSE" MODELS EXCLUDE ITEMS #7,#9, 13, AND #14.

REEL ASSEMBLY REPORTS: R100 (LATCHOUT REMOVAL), R101 (LOCKING RING PLACEMENT), R112 (TIGHTENING AND TORQUING)

REVISION: -

ECO: -

DATE: 4/7/2010

NAME: G. REEDER